

www.klauke.com



Klauke[®] **micro**

The first electromechanical crimping tool
with PowerSense technology

Verbindungen mit **System**
The **POWER** of Partnership

Klauke[®]
A Textron Company

Times change.



And so do requirements.



Klauke® micro

**Fast, light, efficient –
the way you crimp today.**

The new way of crimping for cross-sections up to 50 mm²: Klauke micro. As fast and easy to use as a mechanical crimping tool, as powerful and efficient as a hydraulic tool.

The unique PowerSense technology – “Manual pre-clamping, motorized crimping” makes the crimping process revolutionary simpler and at the same time more efficient than ever.



Micro compact, maximum efficiency

Whether you want high speed, low weight or efficient drive technology, the Klauke micro combines the benefits of manual crimping tools with the convenience of battery-powered hydraulic tools in just one device. Thanks to its compact design it is ideal for jobs where connecting material has to be crimped quickly and in a high volume on the one hand and also wherever a handy, mobile tool is required, e.g. for switch cabinet construction and numerous other installation applications in trade and industry. The Klauke micro is the ideal solution for those who want both – maximum efficiency and optimum ease of use.



Very easy handling
thanks to PowerSense technology



Automatic retraction
when operation is complete



Interchangeable Klauke 50-series crimping dies
for all common applications up to 50 mm²



Electronic control
with blocking function and motor stall protection



High speed
Crimping time < 1.5 sec.



Ergonomic two-component housing
in Klauke “In-line Design”



Very low weight
tool incl. battery < 1 kg



LED light to illuminate
working area



10.8 V lithium-ion battery
with charge level indicator



Long service life
with service intervals of 35,000 cycles



THE REVOLUTIONARY POWERSENSE TECHNOLOGY

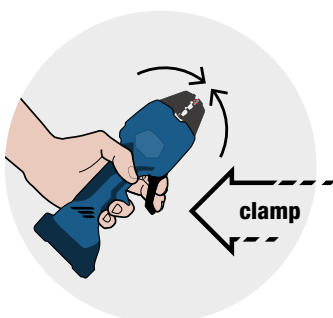

1. Manual pre-clamping

Operating the lever closes the crimping jaws without any exertion on the part of the user and fixes the connecting material. In this “pre-clamped” state it is still possible to adjust the position and the alignment.



Technologies develop.



Versatile

for comfortable crimping of cable connections, cable end-sleeves and cable lugs



Balanced and drop-proof

thanks to key ring for use with balancer or for securing in field work



LED light

to illuminate working area

Smart and powerful

with multi-function LED for maintenance control and data transfer as well as a powerful lithium-ion battery with charge level indicator

Innovative

single-lever control for all tool functions



2. Motorized crimping

Further actuation or “pulling back” the lever starts the crimping process fully automatically using the power of the integrated motor.

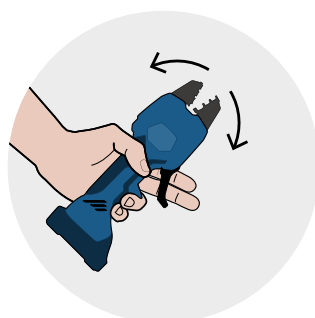

... and done

The retraction to the starting position is also fully automatic. During the entire crimping cycle the process can be interrupted by actuating the lever in the opposite direction.



Klauke® micro

Technical data

| | |
|-------------------------------------|--|
| Crimping force | 15 kN (max.) |
| Crimping range | 0.14 - 50 mm ² |
| Crimping time | < 1.5 sec. (depending on connecting material) |
| Number of crimps per battery charge | approx. 300 at 10 mm ² Cu DIN 46234 |
| Battery voltage | 10.8 V |
| Battery capacity | 1.5 Ah, Li-Ion |
| Charging time | approx. 40 min. |
| Weight incl. battery | 0.96 kg |
| Environmental temperature | -10 °C up to +40 °C |

Suitable for

| |
|---|
| Tubular cable lugs and connectors – Cu, standard design |
| Solderless terminals (DIN 46234) and pin terminals (DIN 46230), solderless connectors (DIN 46341) |
| Cable end-sleeves |
| Insulated cable connections |
| Non-insulated receptacles |

You will find more available dies in our catalogue or at www.klauke.com

Article

| | |
|---|--------|
| Electromechanical crimping tool 0.14 - 50 mm ² | EK50ML |
|---|--------|

Scope of supply

| | |
|---|--------|
| Battery 10.8 V / 1.5 Ah, Li-Ion (16.2 Wh) | RAML1 |
| Charger for 10.8 V Li-Ion batteries, 230 V | LGML1 |
| Crimping die for insulated connectors 0.5 - 6 mm ² | IS5071 |



Accessories

| | |
|-------------|------|
| USB adapter | PGA1 |
|-------------|------|

Variants

| | |
|--|----------|
| Electromechanical crimping tool 0.14 - 50 mm ² with RAM L1 battery, excl. charger, crimping die, plastic case | EK50ML-L |
|--|----------|

Connecting material Crimping range Crimping profile

| | | |
|---|---------------------------|---|
|  | 0.75 - 10 mm ² |  |
|  | 0.5 - 10 mm ² |  |
|  | 0.14 - 50 mm ² |  |
|  | 0.1 - 16 mm ² |  |
|  | 0.25 - 6 mm ² |  |

Strong brands for your success:

Klauke®



Gustav Klauke GmbH
 Auf dem Knapp 46
 42855 Remscheid
 Germany

Phone +49 2191/907-0
 Fax +49 2191/907-141
 Email info@klauke.textron.com
 Website www.klauke.com