

Display LED

Quality retail showcase lighting systems



Specialist LED lighting

Applications:

Showcases
Counters
Window displays
Museums
Exhibitions

Features:

- Low heat
- No ultraviolet rays
- No infra red
- Uniform intensity
- Very long life
- Super slim 15mm diameter profile
- 120 LED's per meter
- Each LED outputs 4000mcd
- Easy clean dustproof diffuser
- Shelf support system with easy adjust shelf holders
- Operates from 12V DC power supply
- Typical life of 30,000 hours
- Large selection of LED colours
- 60 degree beam angle
- Available in lengths up to 2000mm
- Vertical or horizontal mountings available
- Variety of High quality finishes available
- CE & RoHS compliant

Configurations

Fixed One End



Fixed Both Ends



Mounted on Uprights



LED Colour Options



Warm White	3000k - 3500k
Neutral White	4000k - 4500k
Cool White	6000k - 6500k
Colour Adjustable	3000k - 6500k (CCT Controller Required)
RGB	Red, Green, Blue (RGB Controller Required)
RGBW-C	Red, Green, Blue, Cool White (RGBW Controller Required)
RGBW-W	Red, Green, Blue, Warm White (RGBW Controller Required)

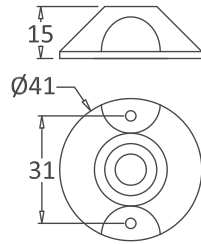

Face Fix - FF15

Diameter	31mm
Height	15mm
Fixing	Screw Fix
Cut Out	7mm
Material	Brass
Finish	See Below

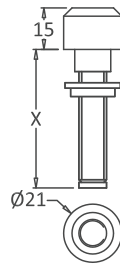

Rear Fix - RF15

Diameter	21mm
Height	15mm
Fixing	M10 Thread
Cut Out	14mm
Material	Brass
Finish	See Below

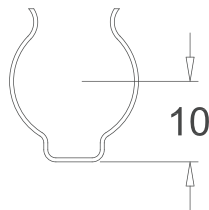

Spring Clip - MC15

Diameter	16mm
Height	20mm
Fixing	Screw Fix
Cut Out	N/A
Material	Spring Steel
Finish	BZP

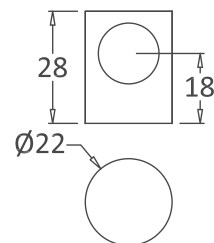

Surface Mount - SF15

Diameter	22mm
Height	28mm
Fixing	Hidden Screw Fix
Cut Out	N/A
Material	Brass
Finish	BZP

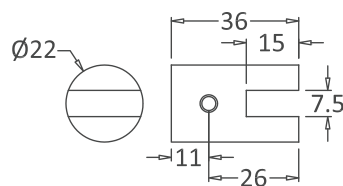

Self Holder - SH15

Diameter	22mm
Length	28mm
Material	Brass
Mount	BZP

How to Order Single & Double Fixed Display LED

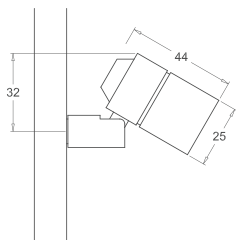

S152			
Lamp	Integral SMD LED	Forward Voltage	3.6V
Power	1.5W	Diameter	25mm
Rotation	350°	Material	Brass
Adjustment	90°		
Class	III		

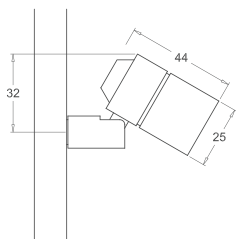

S142			
Lamp	Integral SMD LED	Forward Voltage	3.6V
Power	3.0W	Diameter	25mm
Rotation	350°	Material	Brass
Adjustment	90°		
Class	III		

How to Order Single & Double Fixed Display LED

Order Codes							
Display LED	Overall Length/Height	LED Appearance	Top Fixing	Shelf Holders	Spotlights	Bottom Fixing	Finishes
DLED/12	< 2000mm	CW	BC15	SH +Quantity	S142	FF15	White - 01
		NW	FF15	Example SH10	S152	RF15	Black - 02
		WW	RF15		Example xxx	MC15	Chrome - 03
		CCT	MC15			SF15	Silver - 04
		RGB	SF15				
		RGBW-C					
		RGBW-W					

Please select one reference number from each category. For example **DLED/12.1200.NW.BC15.RF15.03**
 If spotlights and shelf holders are not required please leave blank.

Order Codes

Display LED	Overall Width	LED Appearance	Overall Height	Bottom Fixing	Finishes
DLED/12-EC15	< 1500mm	CW	< 1000mm	FF	White - 01
		NW		RF	Black - 02
		WW		CP	Chrome - 03
		CCT			Silver - 04
		RGB			
		RGBW-C			
		RGBW-W			

Please select one reference number from each category. For example: **DLED/12-EC15.900.WW.300.RF.03**

Display LED Drivers



Display LED Drivers

Code	Description	No. of Spotlights
LED/700-3L	700mA 3W LED Driver	1
LED/700-12L	700mA 12W LED Driver	2 to 4
LED/700-18L	700mA 18W LED Driver	2 to 6
LED/700-36L	700mA 36W LED Driver	4 to 12

IMPORTANT - Constant current LED Drivers **MUST** be wired with parallel connections. Please consult data sheets supplied with the products for wiring instructions.

LED Spotlight Drivers

S152 LED Spotlight Drivers

Code	Description	No. of Spotlights
LED/350-3L	350mA 3W LED Driver	1 to 2
LED/350-12L	350mA 12W LED Driver	2 to 8
LED/350-18L	350mA 18W LED Driver	4 to 12



S142 LED Spotlight Drivers

Code	Description	No. of Spotlights
LED/700-3L	700mA 3W LED Driver	1
LED/700-12L	700mA 12W LED Driver	2 to 4
LED/700-18L	700mA 18W LED Driver	2 to 6
LED/700-36L	700mA 36W LED Driver	4 to 12



IMPORTANT - Constant current LED Drivers **MUST** be wired with series connections. Please consult data sheets supplied with the products for wiring instructions.